

**STORM DRAIN NON LOCKING COVER**

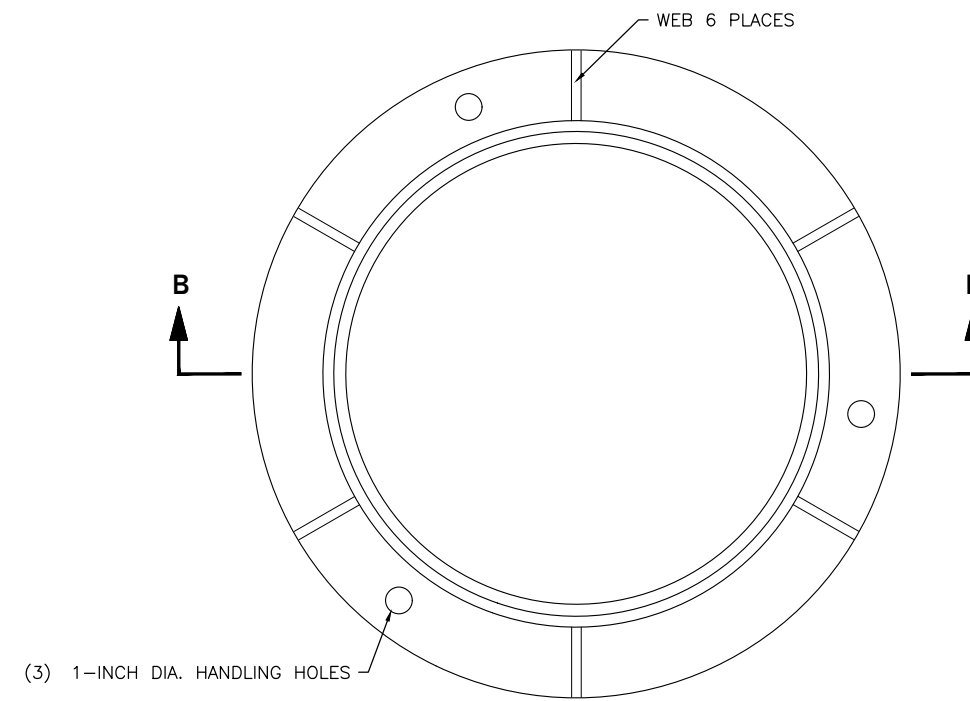

**3715Z STACKING  
GRAY OR DUCTILE IRON FRAME**

**NOTES:**

STANDARD SPECIFICATION SECTION 9-05.15(1) AND 9-06.14

1. COVER SHALL BE AT MINIMUM 100LBS
2. MINIMUM WEIGHT OF FRAME SHALL BE 134 LBS
3. PRODUCT SUPPLIES BY EAST JORDAN IRON WORKS, OR APPROVED EQUAL
4. CITY OF WENATCHEE LOGO REQUIRED
5. FRAME AND COVER SHALL BE H-20 LOADING RATED

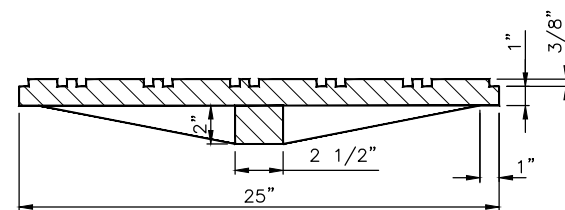

**SECTION A-A - DUCTILE IRON  
NON LOCKING COVER  
MINIMUM WEIGHT 100 LBS.**

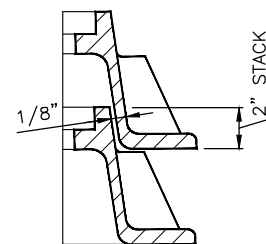

**STACKING DETAIL**

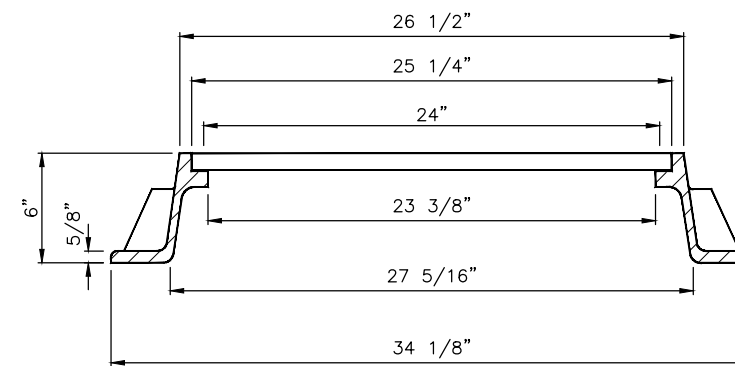

**SECTION B-B  
GRAY IRON OR DUCTILE IRON FRAME  
MINIMUM WEIGHT 135 LBS.**

**STANDARD DETAIL  
CIRCLE FRAME RING  
AND COVER DETAIL**



SCALE: AS SHOWN	DESIGNED	DRAWN	RLK	APPROVED BY	DATE APPROVED	REVISIONS			
						DATE	INITIAL	BY	REASON
						10/03/18	DMN		
						09/17/20	CAW		
						01/01/2022	AJS		
						03/31/2023	JTB		

DETAIL NO.  
**D-100**

PAGE  
**1 OF 1**