

**SANITARY SEWER
NON LOCKING COVER**

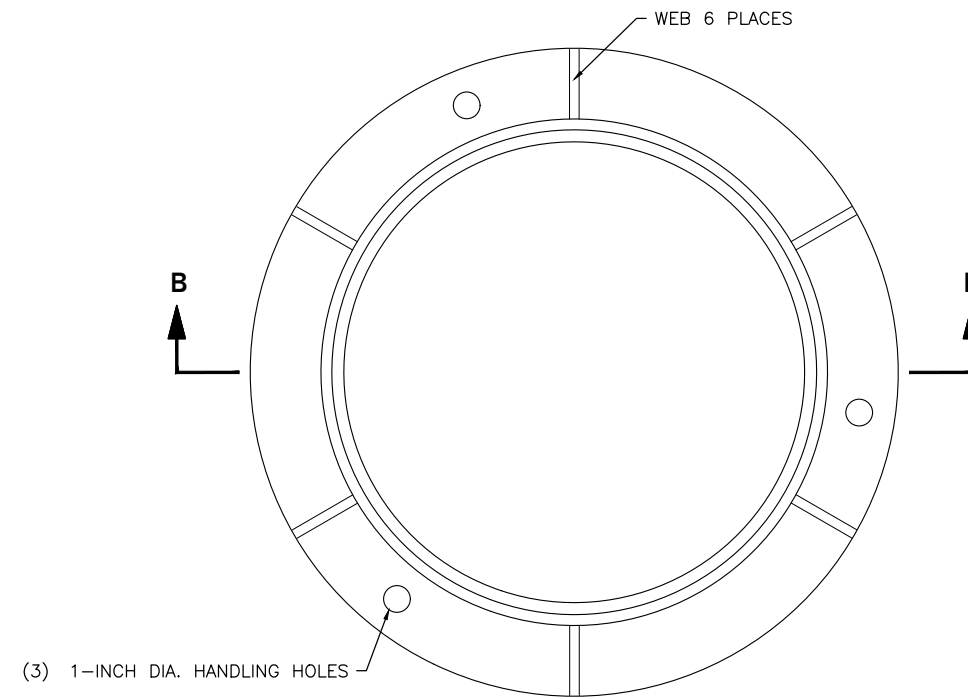

**3715Z STACKING
GRAY OR DUCTILE IRON FRAME**

NOTES:

STANDARD SPECIFICATION SECTION 9-05.15(1) AND 9-06.14

1. COVER SHALL BE AT MINIMUM 100LBS
2. MINIMUM WEIGHT OF FRAME SHALL BE 134 LBS
3. PRODUCT SUPPLIES BY EAST JORDAN IRON WORKS, OR APPROVED EQUAL
4. CITY OF WENATCHEE LOGO REQUIRED
5. FRAME AND COVER SHALL BE H-20 LOADING RATED

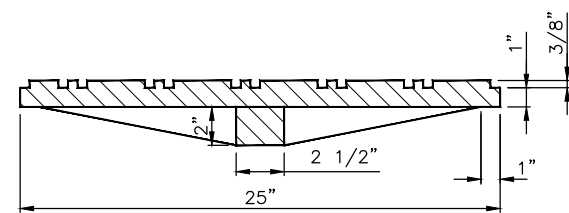

**SECTION A-A - DUCTILE IRON
NON LOCKING COVER
MINIMUM WEIGHT 100 LBS.**

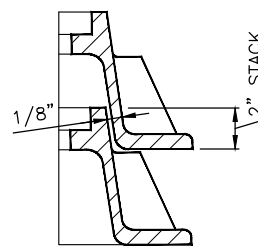

STACKING DETAIL

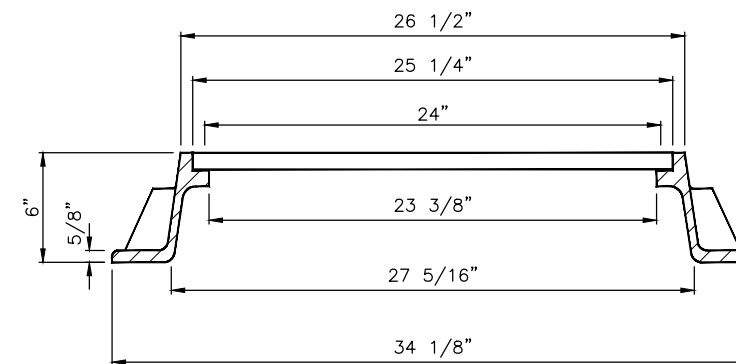

**SECTION B-B
GRAY IRON OR DUCTILE IRON FRAME
MINIMUM WEIGHT 135 LBS.**

**STANDARD DETAIL
CIRCLE FRAME RING
AND COVER DETAIL**



SCALE: AS SHOWN	DATE DRAWN	REVISIONS			
		DATE	INITIAL		
DESIGNED	02/21/06	10/03/18	DMN	09/17/20	CAW
DRAWN	RLK	01/01/2022	AJS	03/31/2023	JTB
CHECKED	SK				
APPROVED BY					

DETAIL NO.

S-150

PAGE

1 OF 1